

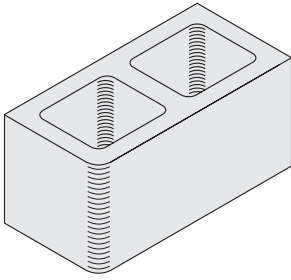

CONCRETE MASONRY UNIT GUIDE

SPECIALTY ITEMS



Bullnose Single-Face

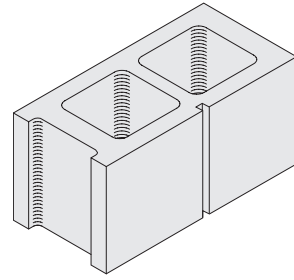

Single Grid

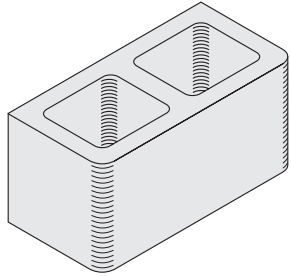

Bullnose Double-Face

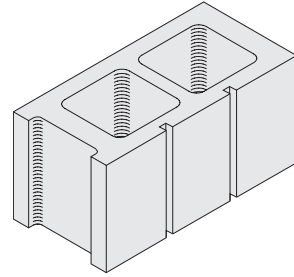

Bi-Grid

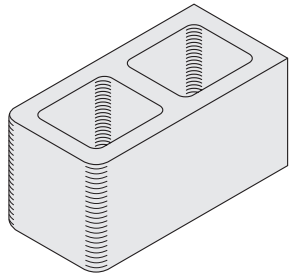

Bullnose Double-End

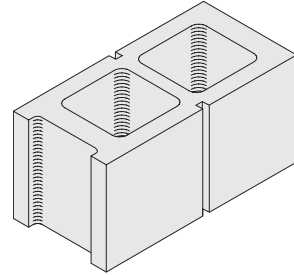

Grid Two Side

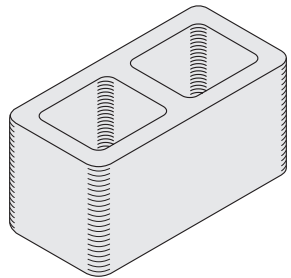

Bullnose Double-Face Double-End

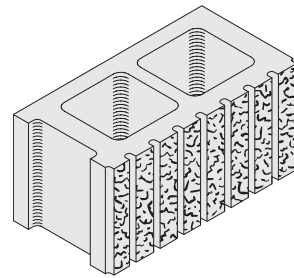

Eight Flute

NOTES:

- Specialty items above can be produced in all shapes and sizes with: Bullnose, Grid, Flute, and Split Face finishes
- Block can be produced in all shapes and sizes using lightweight materials.
- Call for availability and lead time.

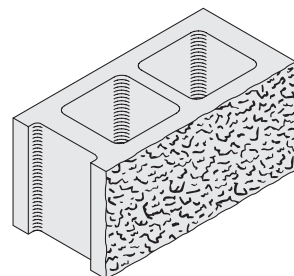

Split Face Block

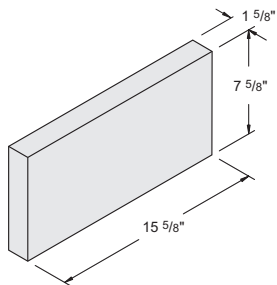

2" x 8" x 16" Solid
#1063000

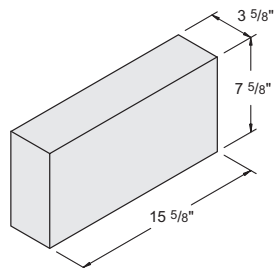

4" x 8" x 16" Solid
#1050080

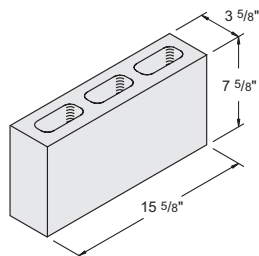

4" x 8" x 16" Hollow
#1050000

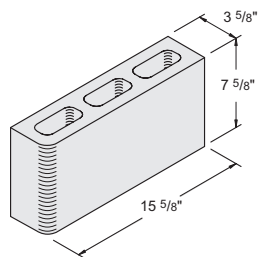

4" x 8" x 16" Bullnose Single-Face
#1050400

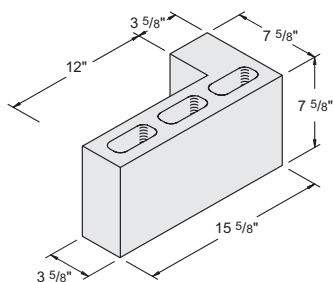

4" x 8" x 16" L Corner
#1050160

WWW.LAMPUS.COM

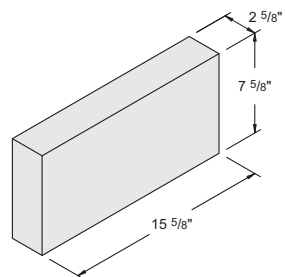

3" x 8" x 16" Solid
#1063010

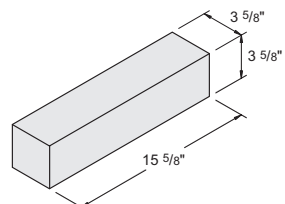

4" x 4" x 16" Solid
#1050060

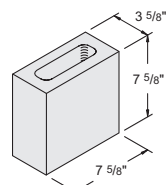

4" x 8" x 8" Half
#1050190

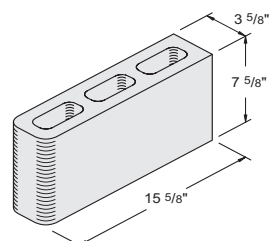

4" x 8" x 16" Bullnose Double-End
#1050410

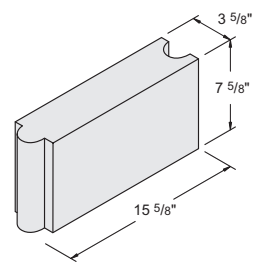

4" x 8" x 16" Mine Block
#1050087

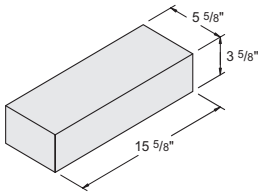

6" x 4" x 16" Solid
#1050070

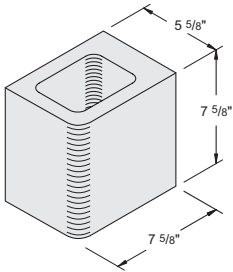

6" x 8" x 8" Half Bullnose Single-Face
#1040240

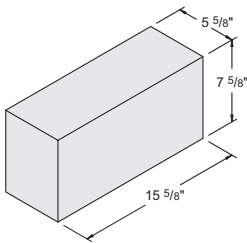

6" x 8" x 16" Solid
#1040020

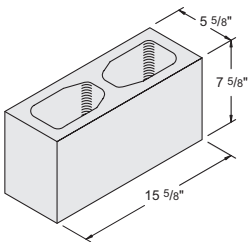

6" x 8" x 16" Hollow Stretcher
#1040000

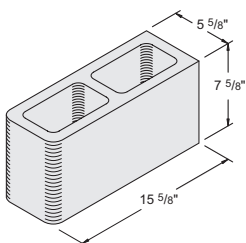

6" x 8" x 16" Bullnose Double-End
#1040080

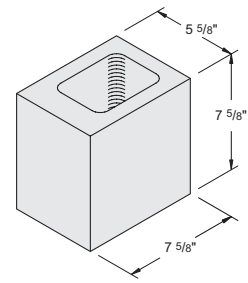

6" x 8" x 8" Half
#1040030

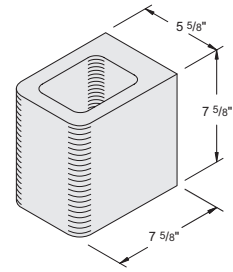

6" x 8" x 8" Half Bullnose Double-End
#1040250

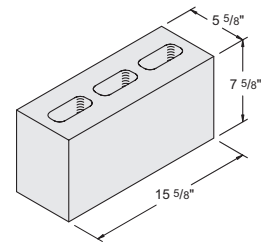

6" x 8" x 16" 75% Solid
#1040200

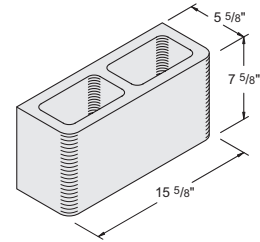

6" x 8" x 16" Bullnose Double-Face
#1040070

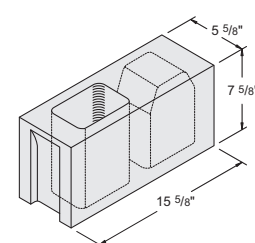

6" x 8" x 16" Anchor Bolt
#1040002

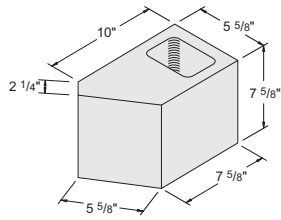

6" 45° Angle
#1040280

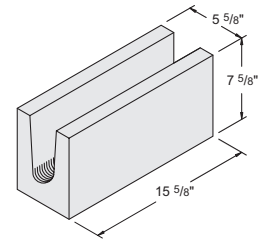

6" x 8" x 16" U-Shaped Lintel
#1040260

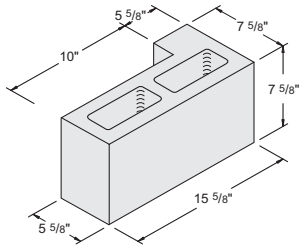

6" x 8" x 16" L Corner
#1040300

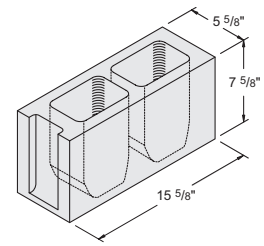

6" x 8" x 16" Termite
#1040010

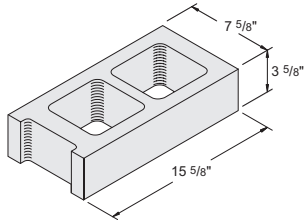

8" x 4" x 16" Half High
#1030180

MIXED: 9 Single Corner, 2 Breaker Jamb, 1 Breaker Double Jamb

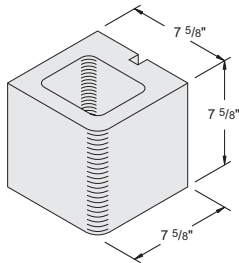

8" x 8" x 8" Half Bullnose Single-Face
#1030280

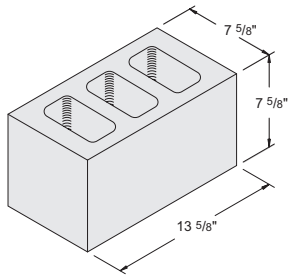

8" x 8" x 14"
#1030270
ALT: 14" Half

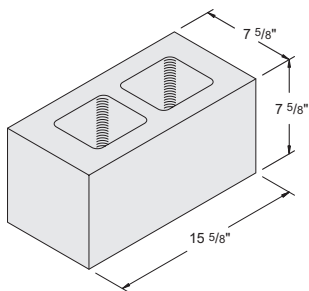

8" x 8" x 16" 57% Solid
#1030340

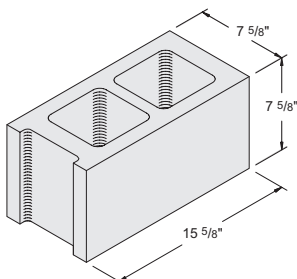

8" x 8" x 16" Hollow Stretcher
#1030000

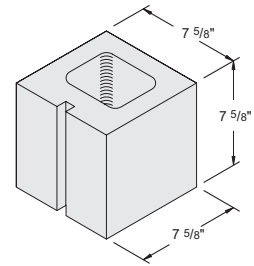

8" x 8" x 8" Half
#1030020

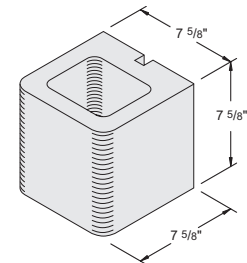

8" x 8" x 8" Half Bullnose Double-End
#1030290

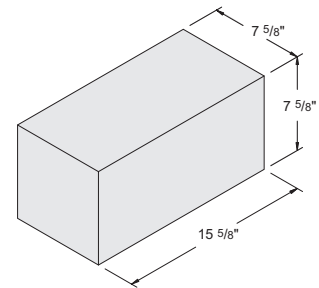

8" x 8" x 16" Solid
#1030140

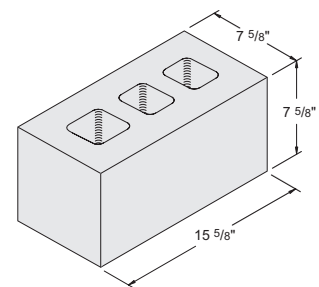

8" x 8" x 16" 75% Solid
#1030410

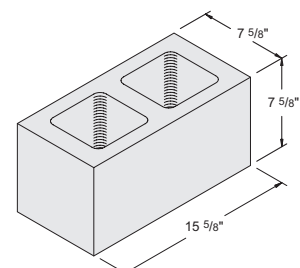

8" x 8" x 16" Pier
#1030050

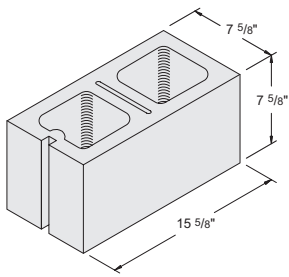

8" x 8" x 16" Splitable Jamb
#1030010

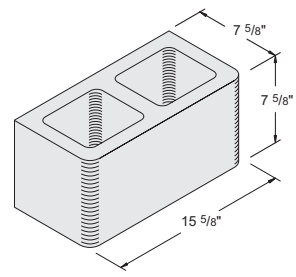

8" x 8" x 16" Bullnose Double-Face
#1030250

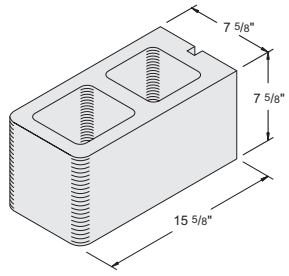

8" x 8" x 16" Bullnose Double-End
#1030260

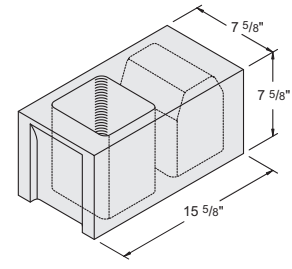

8" x 8" x 16" Anchor Bolt
#1030041

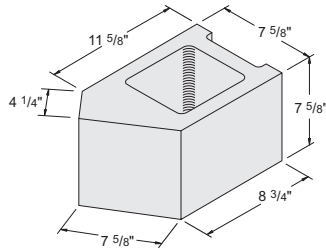

8" 45° Angle
#1030130

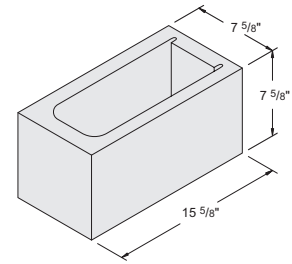

8" x 8" x 16" Beam Lintel (Hairpin)
#1030390

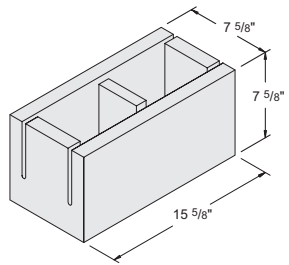

8" x 8" x 16" Bond Beam Knock-Out
#1030120

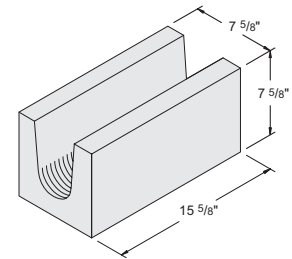

8" x 8" x 16" U-Shaped Lintel
#1030110

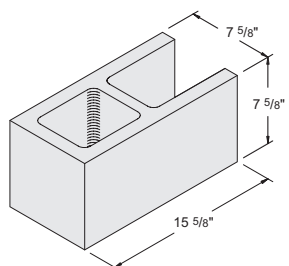

8" x 8" x 16" Conduit
#1030300

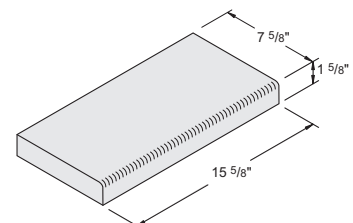

8" x 2" x 16" Curb
#1063025

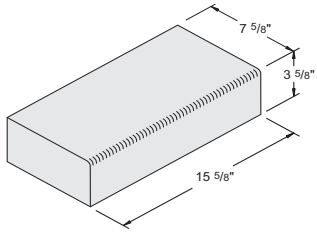

8" x 4" x 16" Curb
#1050085

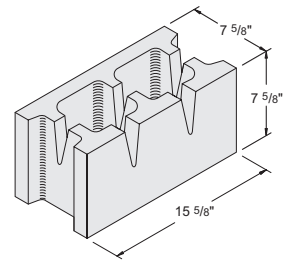

8" x 8" x 16" Drain
#1030002

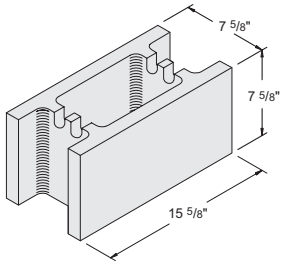

8" x 8" x 16" Grout
#1030230

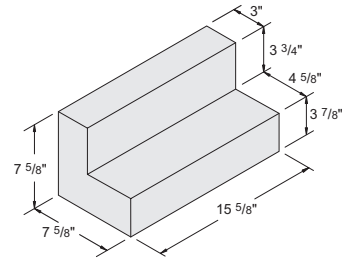

8" x 8" x 16" 4x4 Cut Out Solid Header
#1030175

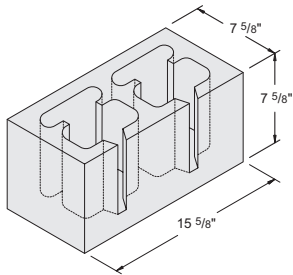

8" x 8" x 16" Soundblox® RSC RF
#1030330

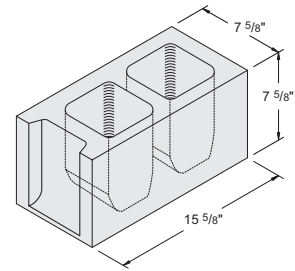

8" x 8" x 16" Termite
#1030040

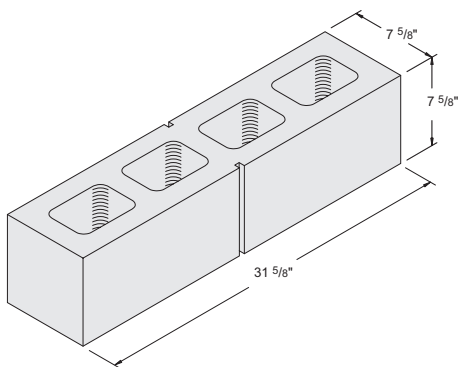

8" x 8" x 32" Double 8
Regular - #1030950 Light Weight - #1030940

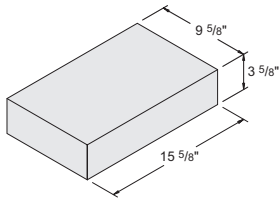

10" x 4" x 16" Solid
#1050090

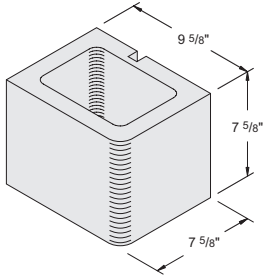

10" x 8" x 8" Half Bullnose Single-Face
#1020170

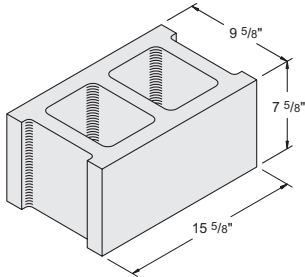

10" x 8" x 16" Hollow Stretcher
#1020000

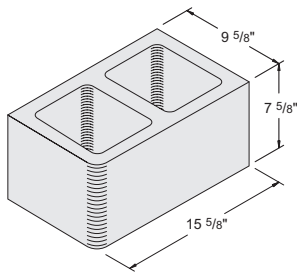

10" x 8" x 16" Bullnose Single-Face
#1020130

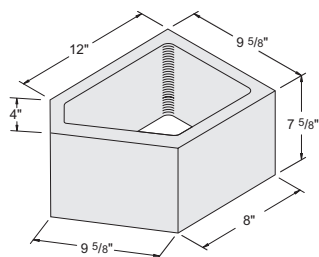

10" 45° Angle
#10200020

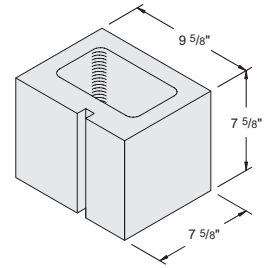

10" x 8" x 8" Half
#1020040

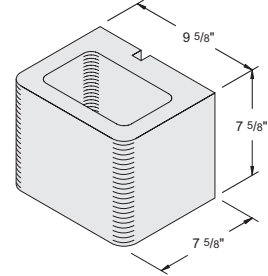

10" x 8" x 8" Half Bullnose Double-End
#1020180

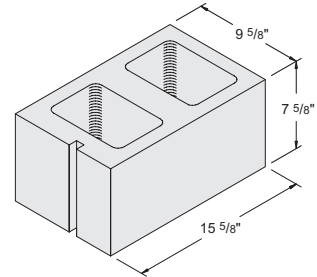

10" x 8" x 16" Jamb
#1020030

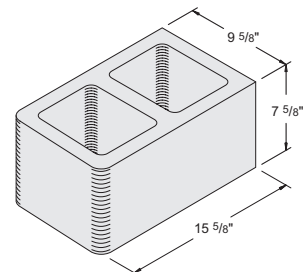

10" x 8" x 16" Bullnose Double-End
#1020190

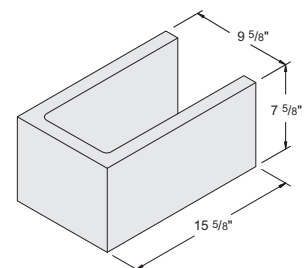

10" x 8" x 16" Beam Lintel (Hairpin)
#1020280

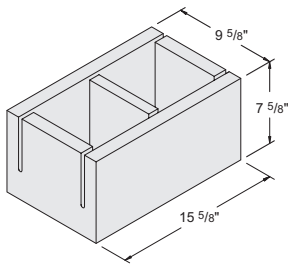

10" x 8" x 16" Bond Beam Knock-Out
#1020100

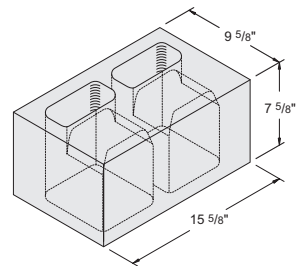

10" x 8" x 16" Brickledge
#1020051

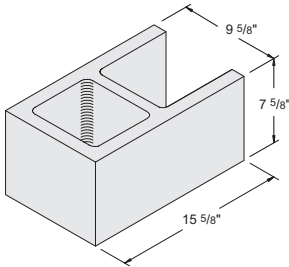

10" x 8" x 16" Conduit
#1020270

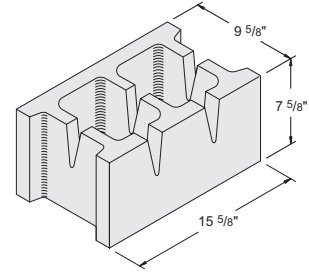

10" x 8" x 16" Drain
#1020080

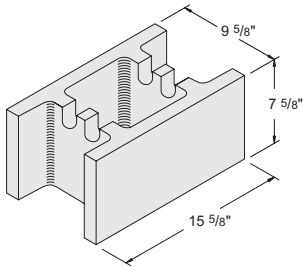

10" x 8" x 16" Grout
#1020070

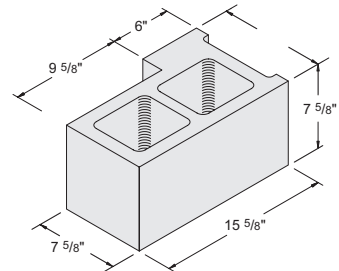

10" x 8" x 16" L Corner
#1020010

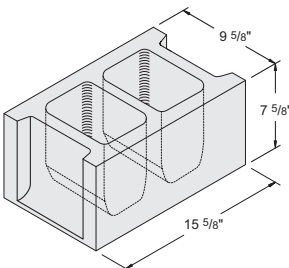

10" x 8" x 16" Termite
#1020050

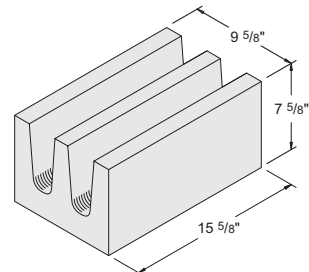

10" x 8" x 16" U-Shaped Lintel
#1020260

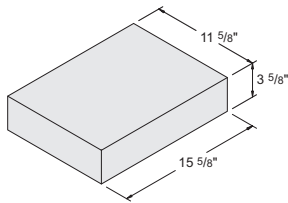

12" x 4" x 16" Solid
#1050100

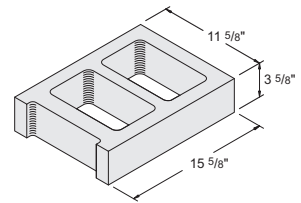

12" x 4" x 16" Half High
#1010180
MIXED: Jamb 1:1 Ratio

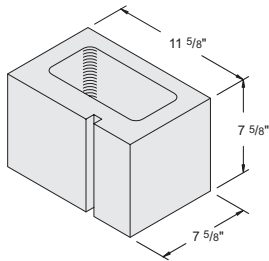

12" x 8" x 8" Half
#1010030

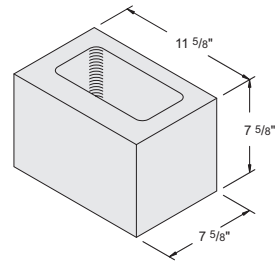

12" x 8" x 8" Half No Slot
#1010130

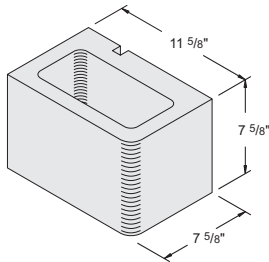

12" x 8" x 8" Half Bullnose Single-Face
#1010590

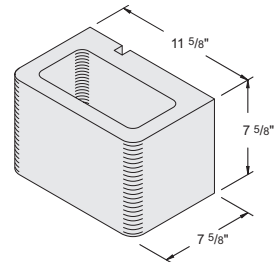

12" x 8" x 8" Half Bullnose Double-End
#1010600

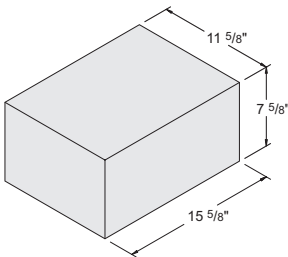

12" x 8" x 16" Solid
#1010160

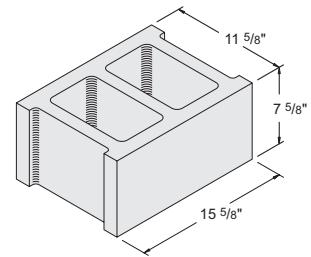

12" x 8" x 16" Hollow Stretcher
#1010000

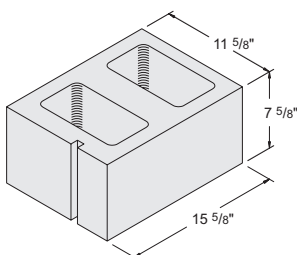

12" x 8" x 16" Jamb
#1010020

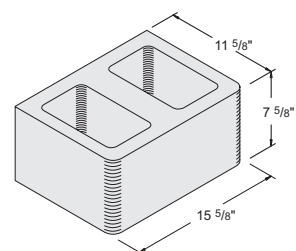

12" x 8" x 16" Bullnose Double-Face
#1010550

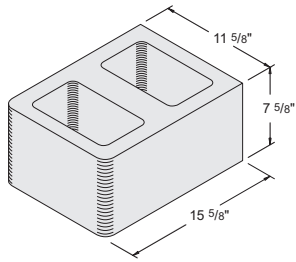

12" x 8" x 16" Bullnose Double-End
#1010540

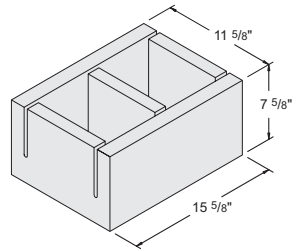

12" x 8" x 16" Bond Beam Knock-Out
#1010050

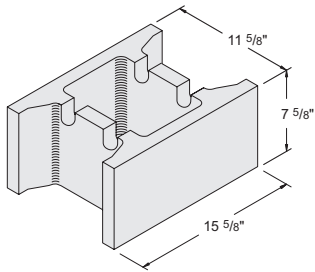

12" x 8" x 16" Grout
#1010220

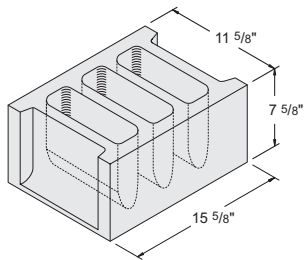

12" x 8" x 16" Termite
#1010040

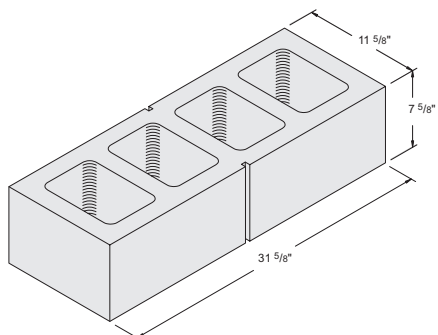

12" x 8" x 32" Double 12
Regular - #1010920 Light Weight - #1010930

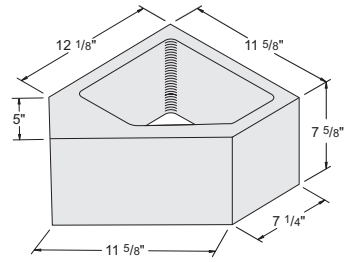

12" 45° Angle
#1010140

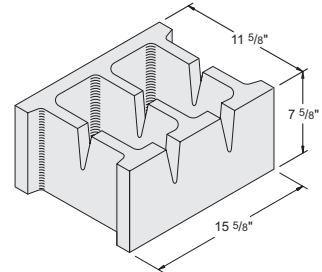

12" x 8" x 16" Drain
#1010012

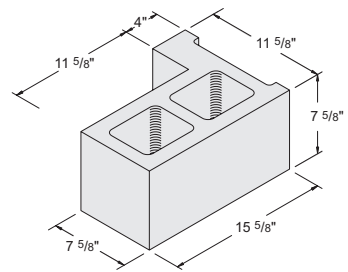

12" x 8" x 16" L Corner
#1010010

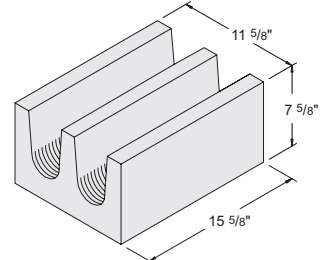

12" x 8" x 16" U-Shaped Lintel
#1010200

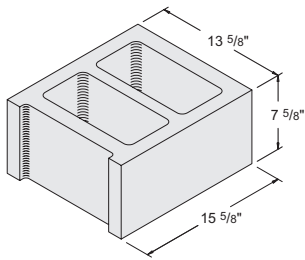

14" x 8" x 16" Hollow Stretcher
#1060000

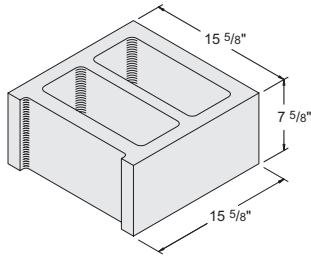

16" x 8" x 16" Hollow Stretcher
#1061000

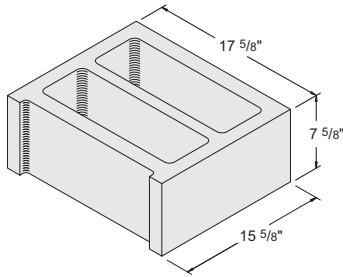

18" x 8" x 16" Hollow Stretcher
#1061500

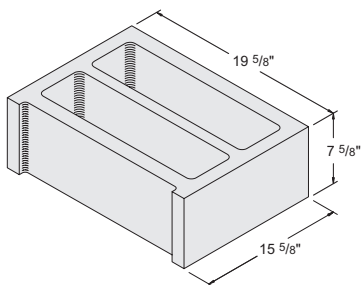

20" x 8" x 16" Hollow Stretcher
#1061520

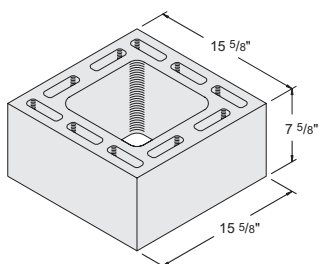

8" x 8" Chimney Block
#1088770

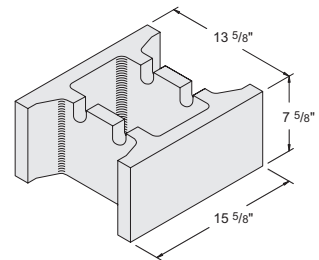

14" x 8" x 16" Grout
#1060010

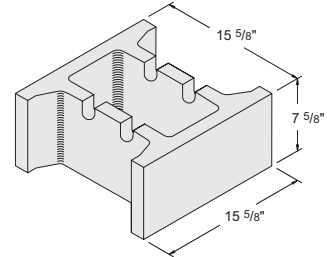

16" x 8" x 16" Grout
#1061030

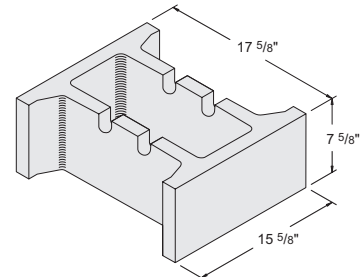

18" x 8" x 16" Grout
#1061510

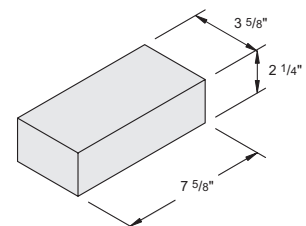

4" x 2 1/4" x 8" Concrete Brick
#1062000

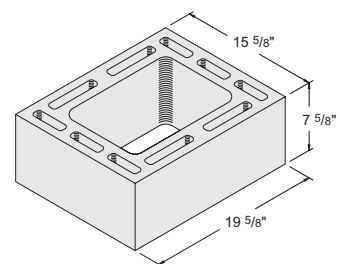

8" x 12" Chimney Block
#1088772

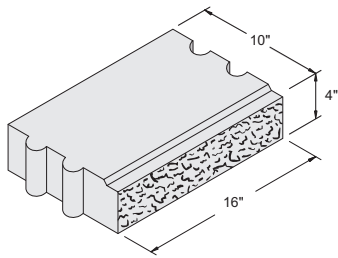

16" x 4" x 10" Dual Lock
#1061050

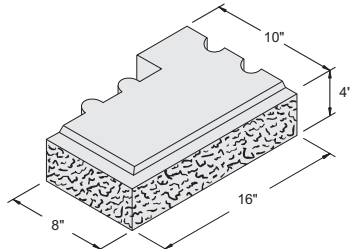

16" x 4" x 10" x 8" Dual Lock
Left Corner #1061071

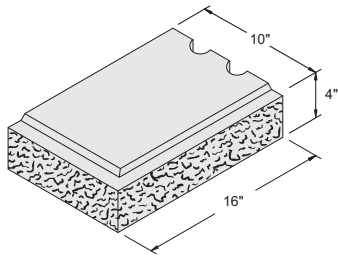

16" x 4" x 10" Dual Lock
Left End #1061081

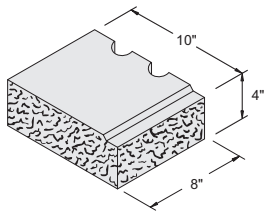

8" x 4" x 10" Dual Lock
Left Half #1061061

DUAL LOCK INSTALLATION:

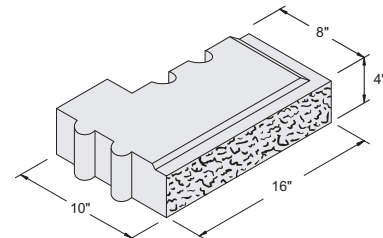
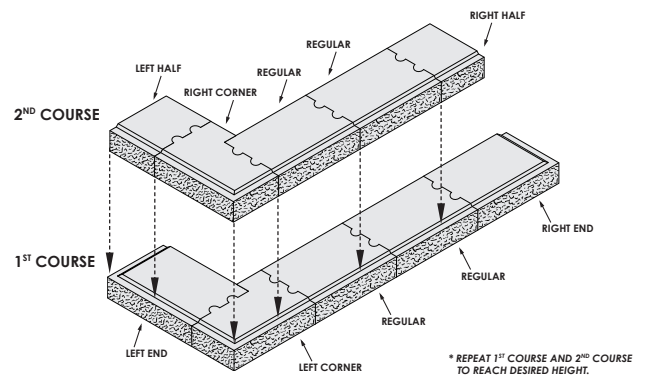

16" x 4" x 10" x 8" Dual Lock
Right Corner #1061072

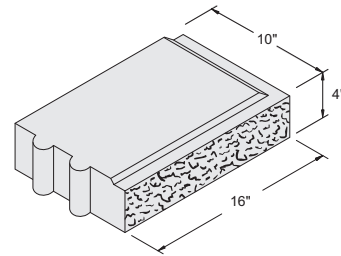

16" x 4" x 10" Dual Lock
Right End #1061082

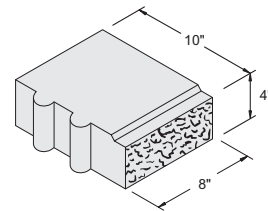

8" x 4" x 10" Dual Lock
Right Half #1061062

SPLITFACE CONCRETE MASONRY

ARCHITECTURAL BLOCK COLOR GUIDE

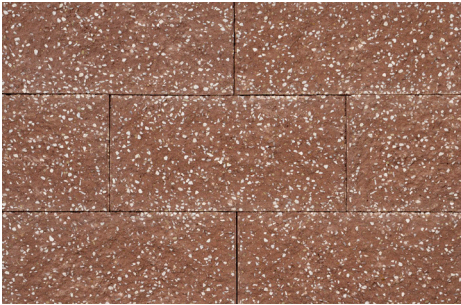

AZTEC RED



BERKLEY RED



CARAMEL



CHARCOAL



CHOCOLATE



LIGHT BROWN



NATURAL

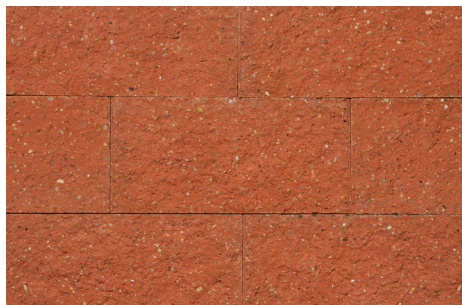

RED

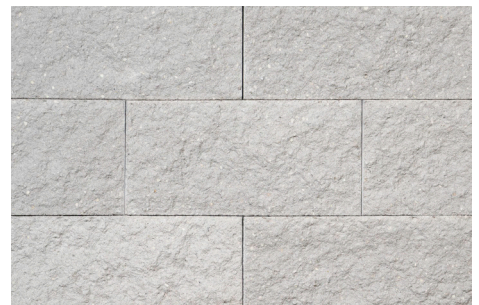

SILVERADO

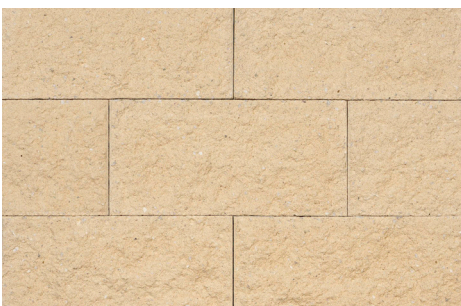

TAN

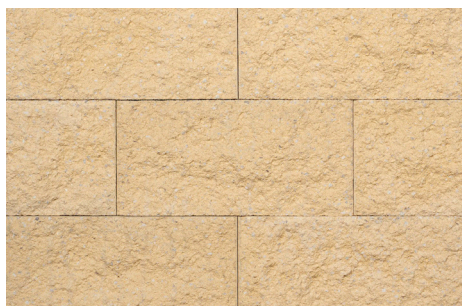

VANILLA



WHITE

ALL COLORS ARE SPECIAL ORDER. CALL YOUR LAMPUS SALES REPRESENTATIVE FOR AVAILABILITY.



816 R.I. Lampus Avenue • PO Box 167 • Springdale, PA 15144 • LAMPUS.COM
Phone: 412.362.3800 • Fax: 724.274.2452 • ©2022 R.I. Lampus Company