

ENGINEERED FOR THE EDGE

Build it right. Build with Sleeve-It.

SLEEVE-IT[®]
by STRATA



CODE COMPLIANT FENCE POST ANCHORING SYSTEM



*Sleeve-It units are palletized
in a stacked, nested format.*

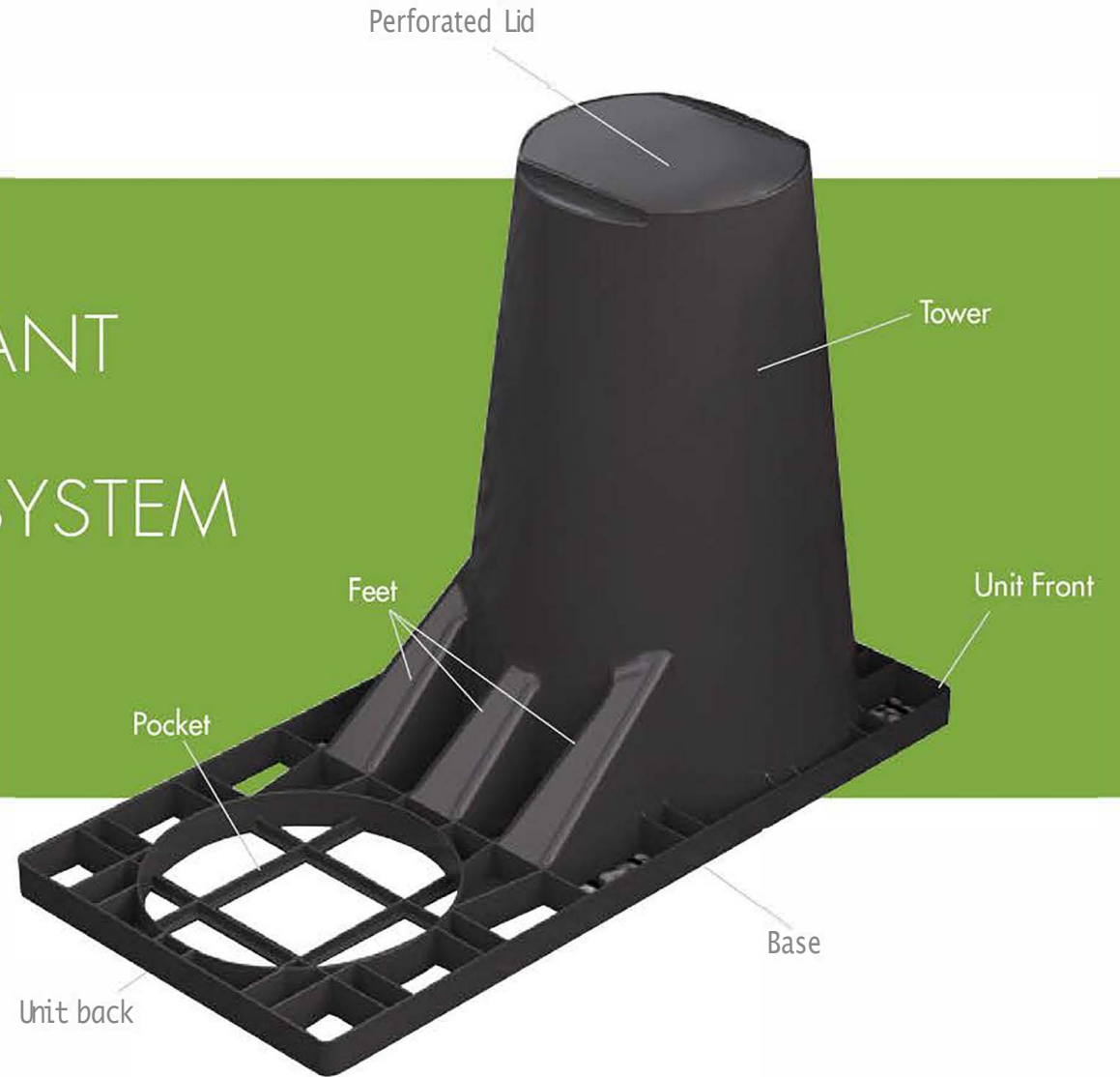



Sleeve-It® SD-1 is a pre-engineered fence post anchoring solution for enhancing below-grade foundational stability in fences placed on top of a segmental retaining wall (SRW). Sleeve-It's patent-pending design allows stable fence footings to be integrated into the support structure of the SRW while it is being constructed. Because of its cantilevered form and other properties, using Sleeve-It during the SRW build permits a code-compliant fence to be constructed, eliminating the 36" offset requirements of IBC 1015.2.



CODE COMPLIANT

Sleeve-It is compliant with
IBC 1015.2, IBC
1607.8.1
and ASCE 7 4.5.1.



MAXIMIZES LAND USE

Eliminates the offset requirement
for roils and fences within 36"
of the edge of the open side of
on SRW.



STACKABLE AND PORTABLE

Lightweight, unitary design makes
Sleeve-It easy to stack, store and transport
to jobsites - reducing stocking space,
shipping costs and labor requirements.



EASY TO INSTALL

Seamlessly integrates into the
SRW construction process and
eliminates the hassle of auguring
once the wall is complete.



COMPATIBLE WITH MOST FENCES

Sleeve-It is designed
to accommodate the
most common SRW
fence types.



RECYCLED MATERIAL

Sleeve-It is made with
- 95% post-consumer
recycled
polypropylene.

INSTALLATION GUIDELINES

SLEEVE-IT[®]

by STRATA

UNIT DIAGRAM

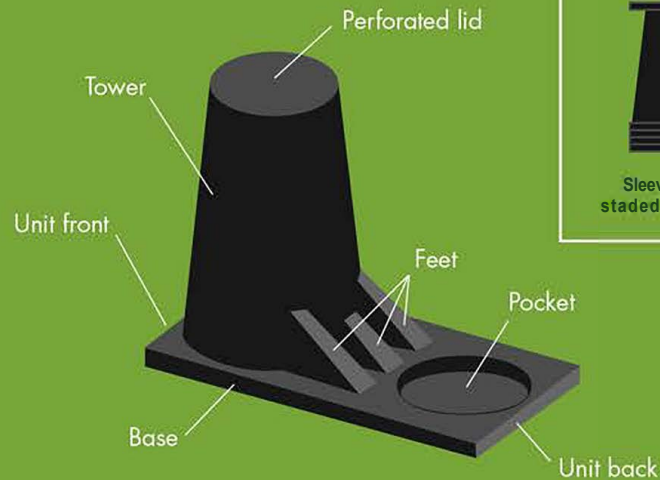

Sleeve-It unit can be stored in a nested format.

STEP 1 Surface Preparation

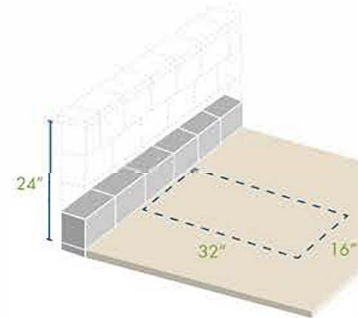

- Prepare a level surface area behind the wall face where the fence post is to be placed.
- The area should be approximately 16" wide by 32" deep.
- The elevation of the base of the Sleeve-It should be approximately 24" below the proposed top of the wall (not including the capstone).

STEP 2 Sleeve-it Placement

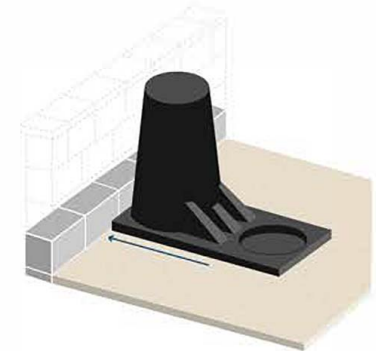

- Place the Sleeve-It unit on the level surface in an upright position with the front edge of the unit flush against the back of the wall.
- Multiple units should be spaced in accordance with fence specifications.

STEP 3 Backfilling Process

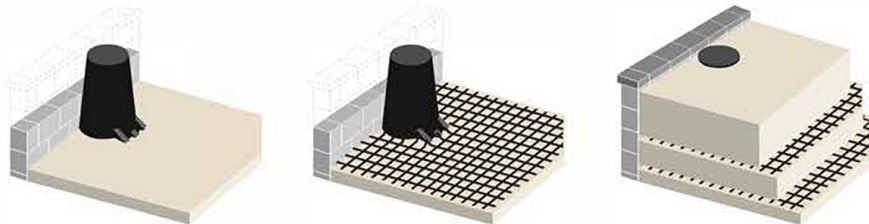

- Encapsulate and stabilize the Sleeve-It unit by placing and compacting sufficient backfill material layers as required.
- If geogrid is required, slit the geogrid perpendicular to the wall face just enough to fit around the base of the unit while ensuring that the geogrid remains properly attached to the wall.
- Continue the backfilling process as directed until the material reaches the top of the tower.
 - Do not remove perforated lid until ready to place post.
 - Do not step on perforated lid, as this could cause serious bodily injury.

STEP 4 Lid Detachment

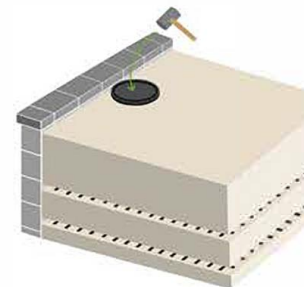

- Punch the perforated lid using a mallet or hammer to expose the inside of the Sleeve-It unit. Detached lids can be left inside the unit or discarded prior to pouring of infill material.

STEP 5 Post Placement

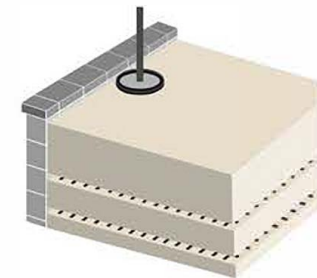

- Place the post through the exposed area and rest on the flat ground surface area inside the Sleeve-It cavity.
- Ensure that the post is upright and level and hold in place while carefully pouring infill material, such as concrete, through the exposed cavity.
 - Follow guidelines specified by infill supplier.
 - Concrete is highly recommended as infill material.

SLEEVE-IT

Product Data Sheet

Sleeve-It SD1 is the only patented fence-post anchoring system that integrates stable fence footings into the support structure of an SRW while it is being constructed. Sleeve-It is a pre-engineered below-grade system for enhancing the fence foundation stability in an SRW taller than 30". Uniquely designed for ease of installation, Sleeve-It also maximizes the useable real estate on top of the wall by eliminating the 36" offset requirement for rails and fences under IBC 1015.2.

COMPOSITION

~95% Post-Consumer Recycled Polypropylene

PROPERTIES	UOM	VALUE*
Total Unit		
Weight	pounds	7
Height	inches	23.4
Width	inches	15.3
Depth	inches	30.6
Volume	feet ³	1.673
Base		
Height	inches	1.5
Perforated Ud		
Lid Aperture	inches	9.4 X 7.4

*Values are nominal.

UNIT DIAGRAM



This information has been carefully compiled by Strata Systems, Inc. and to the best of our knowledge is accurate. Final determination of the suitability of any information or material is the sole responsibility of the user. Structural design shall be performed by a licensed design professional.

Revised 3/2018

1831 North Park Avenue
Burlington, NC 27217
1-800-680-7750
strata@geogrid.com
www.geogrid.com

STRONG. STABLE. SIMPLE.



SLEEVE-IT

by STRATA

Use Sleeve-It to save space, time
and costs on your next project.

orders@geogrid.com
800.680.7750

geogrid.com